

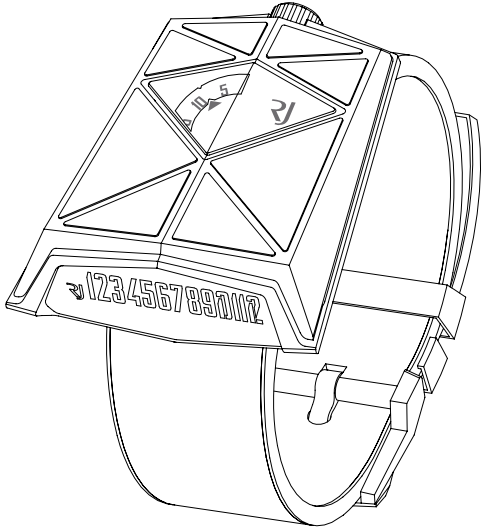

Spacecraft - Modus Operandi

I. ACKNOWLEDGEMENTS | RJ-Romain Jerome would like to thank you for choosing the Spacecraft



You have bought an exceptional timepiece, the result of Swiss watchmaking tradition that combines craftsmanship and know-how with outstanding technological expertise.

Each component in your watch complies with the strict quality control standards imposed by RJ-Romain Jerome master watchmakers.

To guarantee the exclusivity of its designs, each RJ-Romain Jerome timepiece carries an individual number which certifies its authenticity.

Your Spacecraft timepiece is an exclusive creation and a high-end pilot's watch which will give you a lifetime of satisfaction.

II. DNA OF FAMOUS LEGENDS | Measure, capture and celebrate time...

Timepieces in the DNA of Famous Legends collection are inspired by and designed to pay tribute to the great legends of our time.

RJ-Romain Jerome breathes something of history into its creations and thus gives them a real soul.

III. MATERIALS | RJ-Romain Jerome takes great care in the choice of materials used to make its timepieces

It is pushing back design frontiers and using new materials in the manufacture of its watches.

These new materials are combined and used together with precious metal such as red gold.

RJ-Romain Jerome ensures that the origin of all these materials is duly certified by notarised act in Switzerland.

IV. CREATORS LEGENDS | Tribute to watchmaking

With this new capsule collection, RJ aims at offering high-end watchmaking and design to all passionates.

Whether by collaborating with legends of the watchmaking industry, RJ will focus on providing contemporary and innovative products that are different and more accessible.

V. JEAN-MARC WIEDERRECHT | Watchmaker and founder of Agenhor

Jean-Marc Wiederrecht is a contemporary watchmaker little known to the public at large, but highly appreciated by the greatest watch companies for his expertise. When he completed his watchmaker's training in 1972, a time when the industry was in the grips of the quartz crisis, he joined the Châtelain company, where he remained for six years. In 1978, he began a new phase in his career by turning freelance and specialising in the assembly of extra-thin movements.

Ten years later, Jean-Marc Wiederrecht developed his first retrograde perpetual calendar. In 1996, he founded Agenhor SA, a Geneva watchmaking manufacturer specialising in the development of mechanical modules, and in 2007 he was awarded the Best Watchmaker Prize at the Geneva Watchmaking Grand Prix.

VI. ERIC GIROUD | Product designer

Eric Giroud spent his youth in a cultural and artistic environment in Switzerland. In 1995, after having studied music and architecture, he starts working for different creative studios in Switzerland. He discovers and practices graphics, packaging and product design. Designing objects marks the real turning point, a new horizon and a feeling of deep passion. Eric Giroud opens his own design studio in 1998 and mainly focuses on the design and development of timepieces.

At the same period Eric Giroud discovers a delight for contemporary art and becomes a connoisseur and art collector. As a great source of inspiration, visual arts and music play a very important part in his approach to design. He considers his job an interface between man and industry. His method of work is mainly based on human exchanges and research, both stylistic and technical.

VII. MANUEL EMCH | RJ-Romain Jerome CEO

Manuel Emch studied design at the Art Center in La Tour-de-Peilz before gaining a Master's Degree in business at Lausanne University's Faculty of Business and Economics (HEC). The winner of several watch design awards, Manuel Emch is gifted with considerable skills in the field of establishing and consolidating brand identity, which he ably demonstrated at Jaquet Droz, which he revived and repositioned as one of the finest references in the field of Haute Horlogerie.

On January 1st 2010, Manuel Emch joined RJ-Romain Jerome as CEO in order to give it a fresh creative impulse and to establish the credibility and reputation of this youthful brand that shakes up the conventions and clichés often associated with watchmaking. In parallel with his activities in the watch industry, Manuel Emch has for over 20 years nurtured a passion for contemporary art and has built up an eclectic collection.

VIII. SCREW-IN CROWN

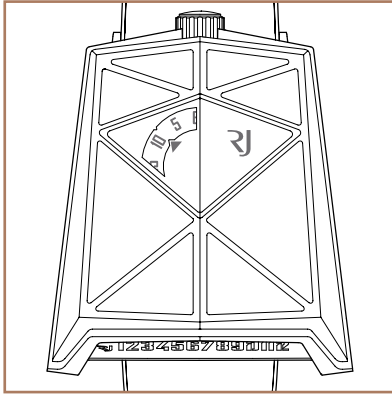

The screw-in crown provide additional protection and increase the case's water resistance. Be sure to never unscrew the crown while under water.

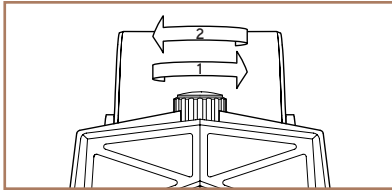

The crown must be unscrewed (1) before performing any operation and screwed back in fully (2) once you have finished using them.

IX. WINDING

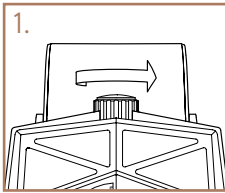

Winding creates the tension required to enable your watch to operate properly.

The watch winds itself "automatically" when on the wrist as the movement caused by creates sufficient energy to operate the mechanism.

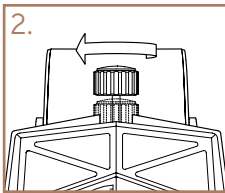

When the watch has not been worn for some time, you will have to wind it "manually":

1. Unscrew the crown
2. Wind by turning the crown about fifteen times
3. Screw the crown back in

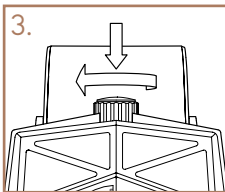

X. SETTING THE TIME

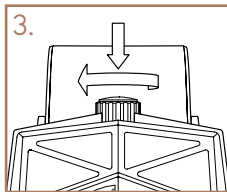
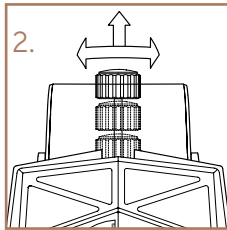
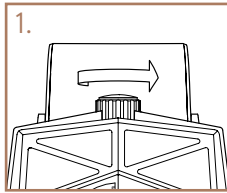

1. Unscrew the crown
2. Pull it to set the minute and hour hands by turning the crown
3. Screw the crown back in

XII. POWER RESERVE

Your Spacecraft is fitted with a selfwinding movement, with 38 hours power reserve.

The power reserve represents the time the watch will operate between 2 manual windings, without wearing the watch.

XIII. MAINTENANCE

Your RJ-Romain Jerome timepiece is protected against temperature variations, perspiration, damp, dust and water thanks to its high quality components.

If exposed to extreme conditions, this protective system may deteriorate with use.

You are strongly recommended to have the water resistance checked every 2 years. Your Spacecraft is water-resistant to a depth of 30 meters.

You are strongly advised to rinse your watch after swimming in the sea.

XIV. WARRANTY

The individual number marked on your RJ-Romain Jerome timepiece certifies its authenticity.

It also identifies the watchmaker who made the watch and ensures monitoring of the complete manufacturing process within our factory.

Your RJ-Romain Jerome watch is guaranteed against all manufacturing defects for 24 months from the date on your warranty card which must be duly completed and signed by an authorised RJ-Romain Jerome dealer.

If, despite all our efforts, your watch requires a repair, take it to your jeweller, along with your warranty.

This warranty does not cover deterioration or damage resulting from incorrect operation, unfortunate accidents, negligence and improper use.

Wear and tear on the strap, the glass and any other action by a third party not authorised by Romain Jerome are not covered by the warranty.

For further information please contact: sav@romainjerome.ch

www.romainjerome.ch