



Octopus - Modus Operandi

I. ACKNOWLEDGEMENTS | RJ-Romain Jerome would like to thank you for choosing the Octopus



You have just bought an exceptional timepiece, the result of Swiss watchmaking tradition that combines craftsmanship and know-how with outstanding technological expertise.

Each component in your watch complies with the strict quality control standards imposed by RJ-Romain Jerome master watchmakers.

To guarantee the exclusivity of its designs, each RJ-Romain Jerome timepiece carries an individual number which certifies its authenticity.

Your Octopus timepiece is an exclusive creation and a high-end diver's watch which will give you a lifetime of satisfaction.

II. DNA OF FAMOUS LEGENDS | Measure, capture and celebrate time...

Timepieces in the DNA of Famous Legends collection are inspired by and designed to pay tribute to the great legends of our time.

RJ-Romain Jerome breathes something of history into its creations and thus gives them a real soul.

III. MATERIALS | RJ-Romain Jerome takes great care in the choice of materials used to make its timepieces

It is pushing back design frontiers and using new materials in the manufacture of its watches.

These new materials are combined and used together with precious metal such as red gold, traditionally used in the design and the creation of luxury watches.

RJ-Romain Jerome ensures that the origin of all these materials is duly certified by notarised act in Switzerland.

IV. TITANIC-DNA | From embodying a legend to the rebirth of an era...

Titanic-DNA is an exclusive and original collection, inspired by the legendary ship that emerged from the Harland & Wolff shipyard in Belfast on April 10th, 1912.

RJ-Romain Jerome pays tribute to the famous ship by incorporating a portion of history into its timepieces.

The timepieces in the Titanic-DNA collection combine complex watchmaking techniques, innovative materials and bold design.

V. RUST | The glory of time past...

Rust derived from melting the Titanic's corroded steel with that provided by the Harland & Wolff shipyard.

Fe₂O₃, iron oxide, more commonly known as "rust", has for long been the enemy of watchmaking and industry generally, since a major concern has been to protect materials from corrosion, which is evidence of the ravages of time on materials.

RJ-Romain Jerome master watchmakers have developed a rust stabilisation process that will protect your oxidised watch against any further corrosion.

VI. BEHIND THE OCTOPUS

The Octopus is named after the ocean giant that became a powerful symbol in Jules Verne's famous novel *Twenty Thousand Leagues under the Sea* and a nod to an urban legend which says that an octopus attacked the Titanic.

It is RJ-Romain Jerome first diver's watch. Every detail recalls the Octopus and the number eight for the number of legs. 8 rivets on each crown, 8 screws on the case itself, 8 screws on the back. The watch is water resistant to 888 feet and is limited to 888 pieces. An octopus is also engraved on the back medallion and the rubber straps features suction cups.

VII. DIVER'S WATCH STANDARD

Each component of its watches goes through a meticulous and dedicated quality check specifically introduced for this collection. The Octopus answers all of the diver's watch standard requirements:

- Unidirectional bezel that must be easily readable at a glance to compute the length of a dive
- Water resistance of greater 1.0 MPa (10 atm), the equivalent of 100 m (330 ft) and must be able to endure the galvanic corrosiveness of seawater
- Thick watch crystals
- Luminescent dials and markers to be legible under the water and in low light conditions

VIII. SCREW-IN CROWNS

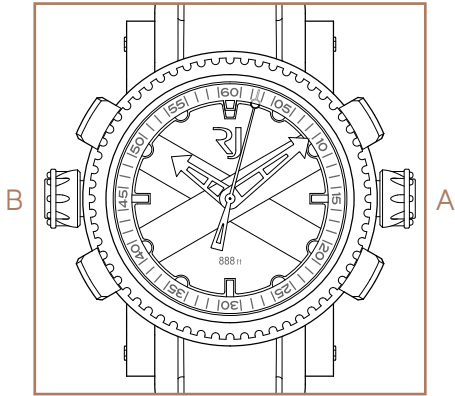

The screw-in crown at 3 o'clock (A) is to set the elapsed dive time controller and the screw-in crown at 9 o'clock (B) to set the time.

The screw-in crowns provide additional protection and increase the case's water resistance. Be sure to never unscrew the crowns while under water.

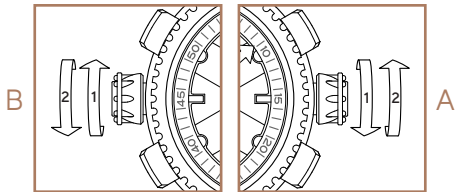

The crowns must be unscrewed (1) before performing any operation and screwed back in fully (2) once you have finished using them.

IX. WINDING

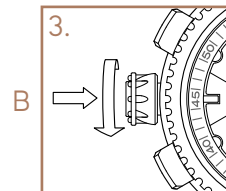
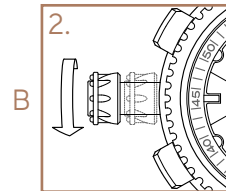
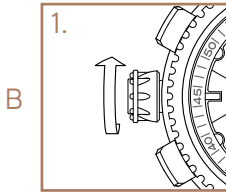

Winding creates the tension required to enable your watch to operate properly.

The watch winds itself "automatically" when the movement caused by wearing creates sufficient energy to operate the mechanism.

When the watch has not been worn for some time, you will have to wind it "manually":

1. Unscrew the crown at 9 o'clock (B)
2. Wind by turning the crown about fifteen times
3. Screw the crown back in

X. SETTING THE TIME

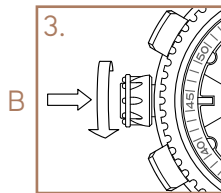
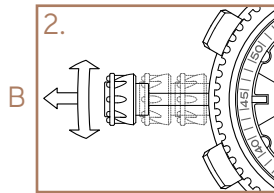
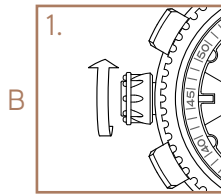

1. Unscrew the crown at 9 o'clock (B)
2. Pull it to set the minute and hour hands by turning the crown
3. Screw the crown back in to ensure water resistance

XI. SETTING THE ELAPSED DIVE TIME CONTROLLER

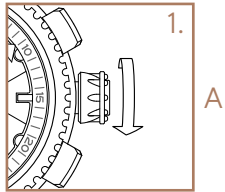

1. Unscrew the crown at 3 o'clock (A)

2. Rotate the internal bezel to set the elapsed dive time controller

3. Screw the crown back in to ensure water resistance

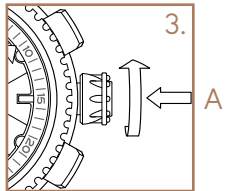
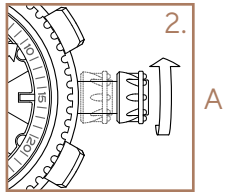

XII. POWER RESERVE

Your Octopus is fitted with a selfwinding movement, with 42 hours power reserve.

The power reserve represents the time the watch will operate between 2 manual windings, without wearing your watch.

XIII. MAINTENANCE

Your RJ-Romain Jerome timepiece is protected against temperature variations, perspiration, damp, dust and water thanks to its high quality components.

If exposed to extreme conditions, this protective system may deteriorate with use.

You are strongly recommended to have the water resistance checked every 2 years. Your Octopus is water-resistant to a depth of 888 feet (270 meters).

You are strongly advised to rinse your watch after swimming in the sea.

XIV. WARRANTY

The individual number marked on your RJ-Romain Jerome timepiece certifies its authenticity.

It also identifies the watchmaker who made the watch and ensures monitoring of the complete manufacturing process within our factory.

Your RJ-Romain Jerome watch is guaranteed against all manufacturing defects for 24 months from the date on your warranty card which must be duly completed and signed by an authorised RJ-Romain Jerome dealer.

If, despite all our efforts, your watch requires a repair, take it to your jeweller, along with your warranty.

This warranty does not cover deterioration or damage resulting from incorrect operation, unfortunate accidents, negligence and improper use.

Wear and tear on the leather strap, the glass and any other action by a third party not authorised by Romain Jerome are not covered by the warranty.

For further information please contact: sav@romainjerome.ch

www.romainjerome.ch